

- LG 101** 3,3 kg/m
- TR** Üst kutu
 - RU** верхняя коробка
 - ENG** Upper box

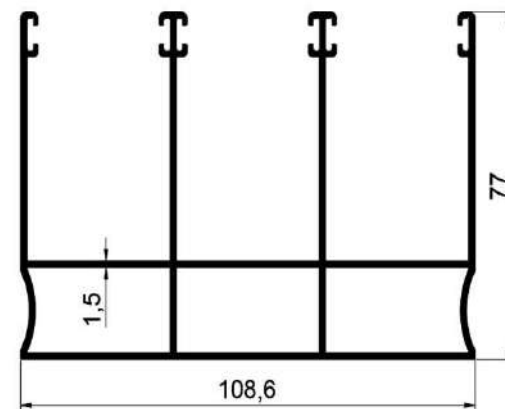

- LG 102** 2,27 kg/m
- TR** Düz yan kasa profili
 - RU** Боковой профиль
 - ENG** Side strut profile

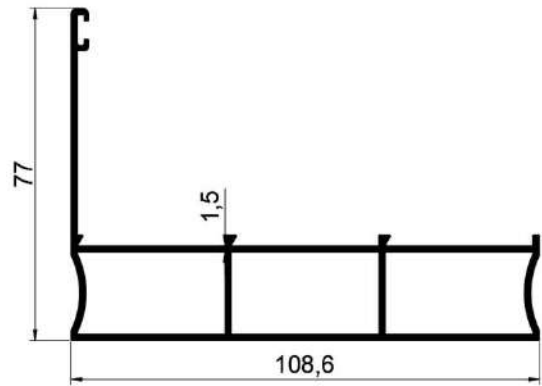

LG 103 1,7 kg/m

- TR** Çıtalı yan kasa profili
- RU** Боковой профиль
- ENG** Side strut profile

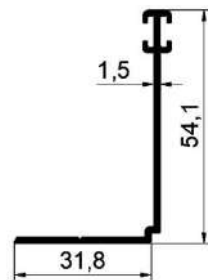

LG 103-1 0,52 kg/m

- TR** Yan kasa iç çita
- RU** профил внутренний
- ENG** Side strut internal profile

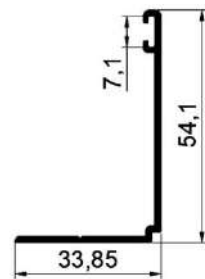

LG 103-2 0,5 kg/m

- TR** Yan kasa dış çita
- RU** профиль наружной
- ENG** Side strut outer profile

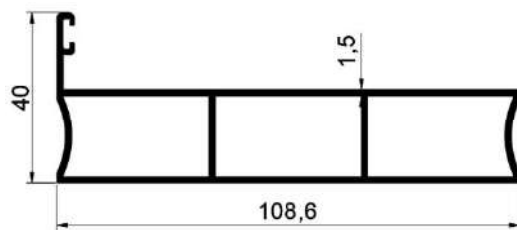

LG 103-1 1,45 kg/m

- TR** Alt kasa
- RU** Основной профиль
- ENG** Bottom profile

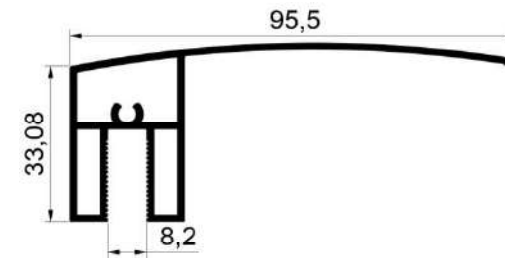

LG 114 0,97 kg/m

- TR** Üst trabzan profili 8mm
- RU** Верхняя профиль 8mm
- ENG** Single glazing upper profile

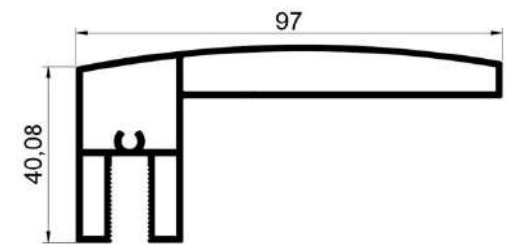

LG 114-1 1,0 kg/m

- TR** Üst trabzan profili 8mm
- RU** Верхняя профиль 8mm
- ENG** Single glazing upper profile

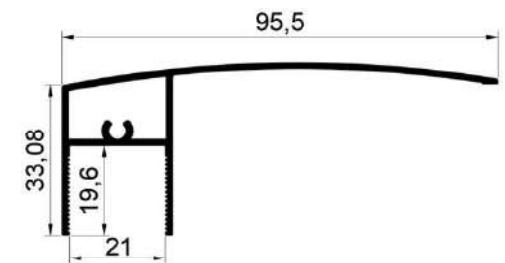

LG 121 0,85 kg/m

- TR** Üst trabzan profili ısıcam
- RU** Верхняя профиль Стеклопакет
- ENG** Double glazing upper profile

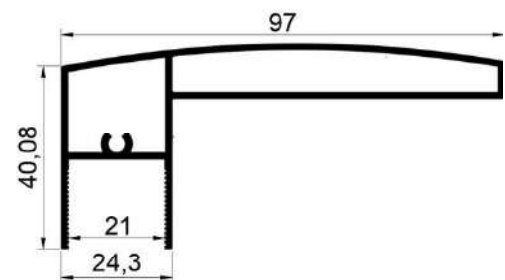

LG 121-1 1,01 kg/m

- TR** Üst trabzan profili ısıcam
- RU** Верхняя профиль Стеклопакет
- ENG** Double glazing upper profile

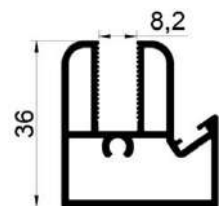
LG 115 0,87 kg/m

- TR** 8mm kenet profil
- RU** профиль зажим
- ENG** Single glazing intermediate profile

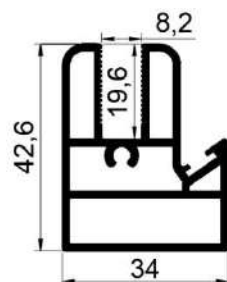
LG 115-1 1,1 kg/m

- TR** 8mm kenet profil
- RU** профиль зажим
- ENG** Single glazing intermediate profile

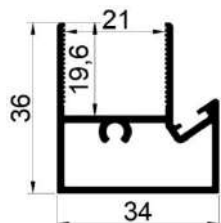
LG 124 0,67 kg/m

- TR** Isıcam kenet profil
- RU** Стеклопакет профиль зажим
- ENG** Double glazing intermediate profile

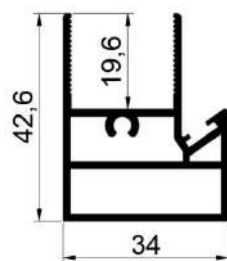
LG 124-1 0,9 kg/m

- TR** Isıcam kenet profil
- RU** Стеклопакет профиль зажим
- ENG** Double glazing intermediate profile

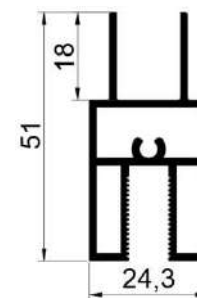
LG 112 0,84 kg/m

- TR** 8mm yan kanat
- RU** Боковой профиль
- ENG** 8 mm side strut profile

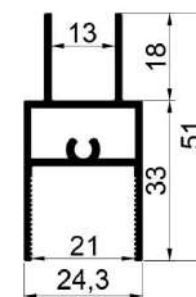
LG 122 0,65 kg/m

- TR** Isıcam yan kanat
- RU** Боковой профиль Стеклопакет
- ENG** Double glazing side strut profile

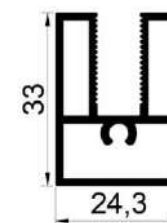
LG 113 0,67 kg/m

- TR** Alt kanat profil
- RU** Створочный профиль
- ENG** bottom profile

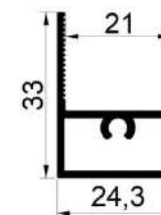
LG 123 0,55 kg/m

- TR** Isıcam alt kanat profil
- RU** Створочный профиль Стеклопакет
- ENG** Double glazing bottom profile

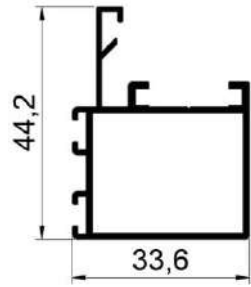
LG 132 0,6 kg/m

- TR** Vasistas kasa profil
- RU** Боковой профиль vasistas
- ENG** Vasistas main profile

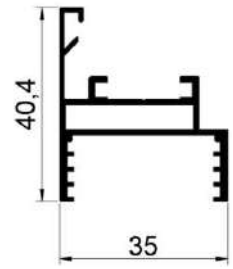
LG 132-1 0,6 kg/m

- TR** Vasistas kanat profil
- RU** Створочный профиль
- ENG** Vasistas bottom profile

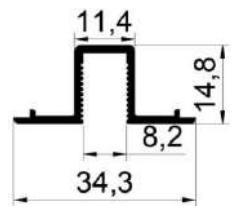
LG 133 0,35 kg/m

- TR** 8mm düşerme çitası
- RU** Створочный профиль
- ENG** Vasistan 8 mm panel profile

LG 207-1 ÇELİK TELLİ KAYIŞ

Steel String Band / Стальной Ременный Провод

LG 209 KUTU YAN KAPAK

Box Side Cover / Боковая крышка коробки

LG 105 YAN KASA KAPAK

SIDE CASE PROFILE / ПРОФИЛЬ БОКОВОЙ СТОРОНЫ

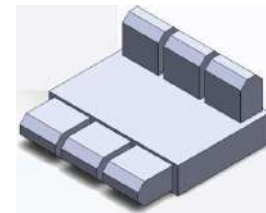
LG 201 4'LÜ KÖŞE TAKOZU

Corner Part / Угловой Соединитель Рамы

LG 202 MOTOR YATAĞI

Head For / Подшипник

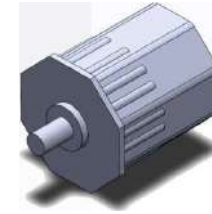
LG 203 BORU BAŞI

Head For Pipes / Заглушка в октогональный вал

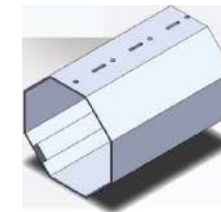
LG 204 TAMBUR BORUSU

Profile / Вал октогональный

LG 206 DİŞLİ KASNAK

Pulley / Шкив под цепь

LG 206-1 GIYOTİN ZİNCİRİ

Chain / Шкив под ремен

LG 207 KASNAK

Pulley / Обручень